



2 The limes, Windsor, Berkshire, SL4 4US
£348,995

 **HORLER**

2 The limes, Windsor, Berkshire, SL4 4US

Located in the sought-after area of The Limes, Windsor, this charming ground-floor maisonette offers comfortable and convenient living. The property features two spacious double bedrooms, a well-fitted kitchen, and a modern family shower room. A standout feature is the bright conservatory overlooking the private rear garden, complete with a patio area and mature shrubs, creating a peaceful space for relaxation or entertaining. Ideally situated close to local amenities, schools, parks, and excellent transport links, this home is perfect for families, professionals, or those looking to downsize.



Property Summary

This charming two double bedroom ground floor maisonette located in the desirable area of The Limes, Windsor. This delightful property offers a perfect blend of comfort and convenience, making it an ideal choice for families or professionals alike.

As you enter, you will find a well-fitted kitchen that provides ample space for culinary creations. The layout is practical and inviting, ensuring that meal preparation is a pleasure. The family shower room is modern and functional, catering to the needs of everyday life.

One of the standout features of this maisonette is the lovely conservatory, which overlooks the rear garden. This bright and airy space is perfect for relaxation or entertaining, with views of the patio area and mature shrubs that create a tranquil outdoor setting. The garden offers a wonderful opportunity for gardening enthusiasts or simply enjoying the fresh air.

Situated in a prime location, this property is conveniently close to local amenities, schools, and transport links, making daily commutes and errands effortless. The surrounding area boasts a friendly community atmosphere, with parks and recreational facilities nearby.

In summary, this ground floor maisonette in The Limes, Windsor, presents an excellent opportunity for those seeking a comfortable home in a vibrant location. With its appealing features and proximity to essential services, it is a property not to be missed.

General information:

Council tax band 'D'

Lease remaining:

Service charge: Approx.

Ground rent: Approx.

Legal Note

Although these particulars are thought to be materially correct their accuracy cannot be guaranteed and they do not form part of any contract





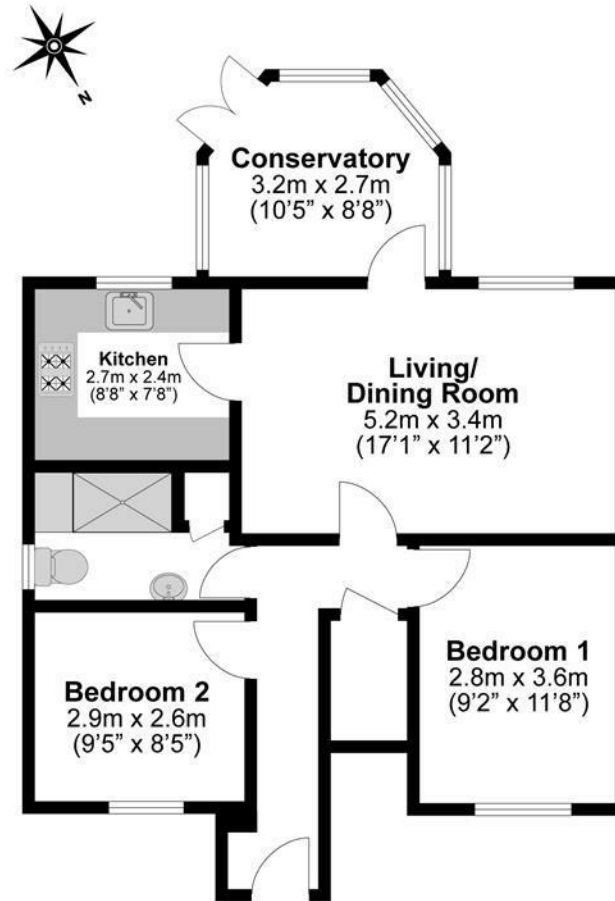

**Illustrations are for identification purposes only,
measurements are approximate, not to scale.**